

# V-CAP

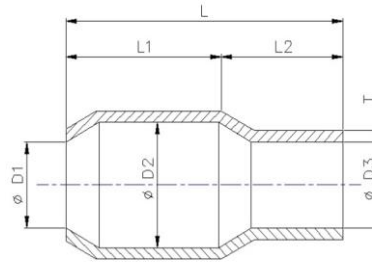

## FLEXIBILITY

MATERIAL HIGH

MIT108  
 MIT108S  
 MIT108SR (ZINC PROTECH)  
 MIT108HT (HIGH TEMP)

MIT107  
 MIT107BX

MIT106  
 MIT106S

LOW

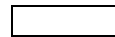
 CURRENT PART

## COLORS

NORMAL COLOR-----BLACK=B, BLUE=BL, YELLOW=Y, GREEN=G, RED=R

SPECIAL COLOR-----CLEAR=C, PINK CLEAR= P-C, BLUE CLEAR=B-C, YELLOW CLEAR=Y-C

PART NO.	D1 (MM)	D2 (STD.)	D3 (General)	L ± 2.0 (MM)	L1 ± 1.0 (MM)	L2 ± 1.0 (MM)	T (STD.)	Stock Code.
VC-1.25	2.8	3.3	3.1	13.0	6.0	7.0	0.6 +0,-0.2	
VC-2	3.3	4.5	3.7	14.0	7.0	7.0	0.7 +0,-0.2	MIT012
VC-3.5	4.2	5.7	4.1	17.0	9.0	8.0	0.8 +0,-0.2	MIT014
VC-5.5	4.8	5.7	5.2	17.0	9.0	8.0	0.8 +0,-0.2	
VC-8	6.2	7.2	6.2	19.0	10.0	9.0	1.0 +0,-0.2	MIT017
VC-14	7.5	10.0	8.0	25.0	14.0	11.0	1.1 +0,-0.3	MIT035
VC-22	10.5	12.0	9.5	30.0	15.0	15.0	1.2 +0,-0.3	
VC-38	12.5	14.0	11.8	34.0	17.5	16.5	1.5 +0,-0.3	MIT060
VC-60	15.0	17.0	13.9	39.0	20.0	19.0	1.5 +0,-0.3	MIT080
VC-80	17.0	19.5	16.0	47.0	25.0	22.0	1.6 +0,-0.3	
VC-100	19.0	22.0	18.0	54.0	30.0	24.0	1.8 +0,-0.4	MIT140
VC-125	21.0	24.4	20.0	57.0	32.0	25.0	1.8 +0,-0.4	MIT180
VC-150	23.0	24.4	22.0	65.0	35.0	30.0	2.0 +0,-0.4	MIT200
VC-200	27.0	32.2	24.0	65.0	35.0	30.0	2.0 +0,-0.4	
VC-250	29.0	37.5	26.5	77.0	35.0	42.0	2.5 +0,-0.5	
VC-325	29.0	37.5	30.0	77.0	37.0	40.0	2.5 +0,-0.5	

MAH-16	8.0	10.0	8.0	24.0	13.0	11.0	1.2 +0,-0.3	
MAH-25	10.0	12.0	9.5	29.0	15.0	14.0	1.2 +0,-0.3	
MAH-35	12.0	14.0	11.0	33.0	17.0	16.0	1.5 +0,-0.3	
MAH-50	13.0	17.0	12.5	39.0	20.0	19.0	1.5 +0,-0.3	
MAH-70	15.0	19.5	14.0	46.0	25.0	21.0	1.5 +0,-0.3	
MAH-95	17.0	22.0	16.3	54.0	30.0	24.0	1.8 +0,-0.4	
MAH-120	19.5	24.4	18.5	57.0	32.0	25.0	1.8 +0,-0.4	
MAH-150	21.0	24.4	20.1	65.0	34.0	31.0	1.8 +0,-0.4	
MAH-185	24.5	30.0	22.5	65.0	35.0	30.0	2.0 +0,-0.4	
MAH-240	26.0	33.0	25.5	77.0	35.0	42.0	2.0 +0,-0.4	
MAH-300	29.0	34.0	28.0	77.0	37.0	40.0	2.0 +0,-0.4	
MAH-400	36.0	42.0	36.0	84.0	44.0	40.0	2.0 +0,-0.4	
MAH-500	39.5	45.0	39.5	80.0	46.0	34.0	2.2 +0,-0.5	

Others Size without in This table .Pls contact 02-0108580



三本タイランド  
**No.1 of CAP**

